

G-iron ArmoFlex®

High permeability shielding metallic woven

Supply modality:	Roll			
Roll weight:	65.80 kg			
Roll length:	24.5 m			
Roll width:	642 mm			
Weight:	n° 1 layer = 4.18 Kg/m ² n° 2 layers = 8.36 Kg/m ²			
Thickness:	n° 1 layer = 0.73 mm n° 2 layers = 1.46 mm			
Minimum radius of curvature:	50 mm			
Protective coating:	aluminum coating with single-sided tape 150 µm thick on both sides			
100 µT reduction factor into contact with the screen, 1st layer:	Vertical polarisation		Horizontal polarisation	
	<i>attenuation percentage</i>	<i>attenuation ratio</i>	<i>attenuation percentage</i>	<i>attenuation ratio</i>
	88 %	8.23	89 %	8.4
100 µT reduction factor into contact with the screen, 2nd layer:	Vertical polarisation		Horizontal polarisation	
	<i>attenuation percentage</i>	<i>attenuation ratio</i>	<i>attenuation percentage</i>	<i>attenuation ratio</i>
	97 %	35.05	97 %	33.82
Maximum operating temperature with coating:	Store in a covered, dry place, protected from any atmospheric agent. It is recommended to open the packaging only when needed for the shielding system laying.			

NOTE:

Always handle while wearing protective gloves and never cut G-iron SuperFlex with sanders, disks or any method that could heat up the material.

The information and data embodied in this document and its attachments are strictly confidential and are supplied on the understanding that they will be held confidential and will not be disclosed to other parties.

1) PLACEMENT

G-iron ArmoFlex® is directly placed on the desired surfaces through a suitable furniture hardware (plugs, nails, screws, double-sided tape, glues, resins, etc..) chosen considering the substratum characteristics. Based on the desired surface for the shielding, the material can be placed pulling together the extremities or by putting the sheets on top of each other by 40mm. If angles or curvatures are found, the shielding material will be shaped manually with the help of a reference ruler.

- Soffit

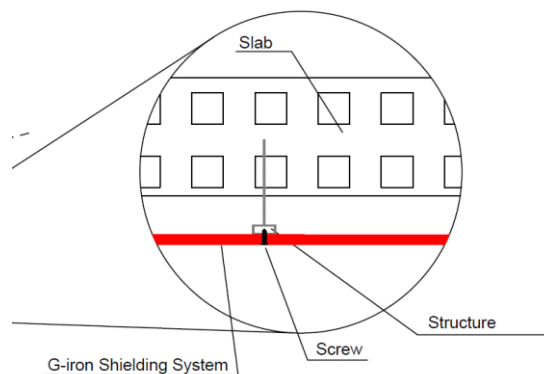
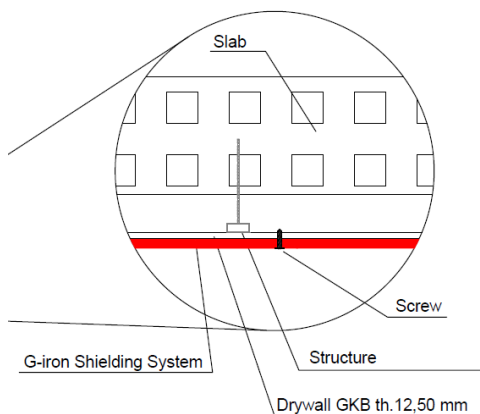
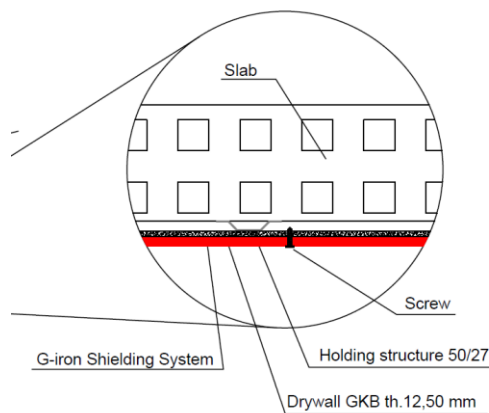
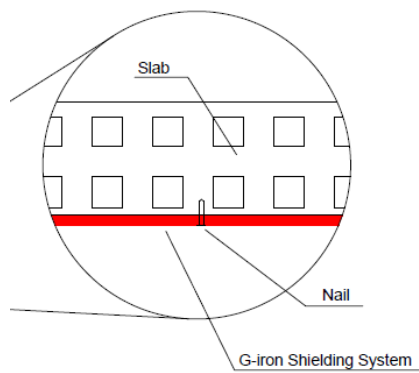

- Walls

The information and data embodied in this document and its attachments are strictly confidential and are supplied on the understanding that they will be held confidential and will not be disclosed to other parties.

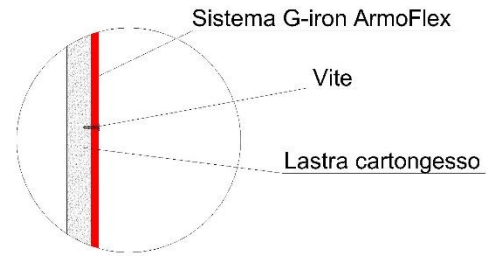
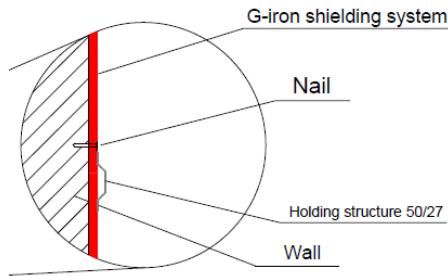
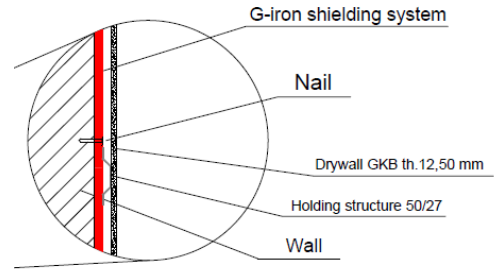
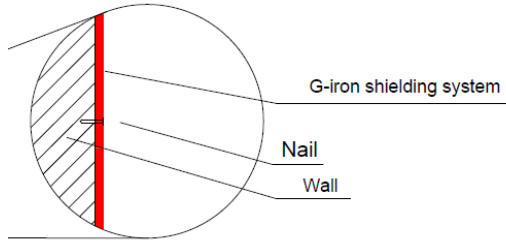

Piano di calpestio

- Sotto massetto

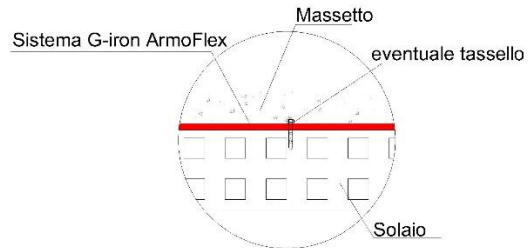
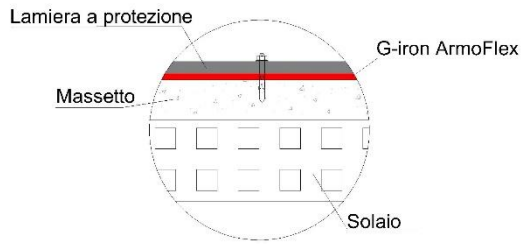

The information and data embodied in this document and its attachments are strictly confidential and are supplied on the understanding that they will be held confidential and will not be disclosed to other parties.



Fig. 1 ArmoFlex



Fig. 2 band of ArmoFlex

The information and data embodied in this document and its attachments are strictly confidential and are supplied on the understanding that they will be held confidential and will not be disclosed to other parties.



Fig. 3 installation on walls (ArmoFlex) and ceiling (SuperFlex)

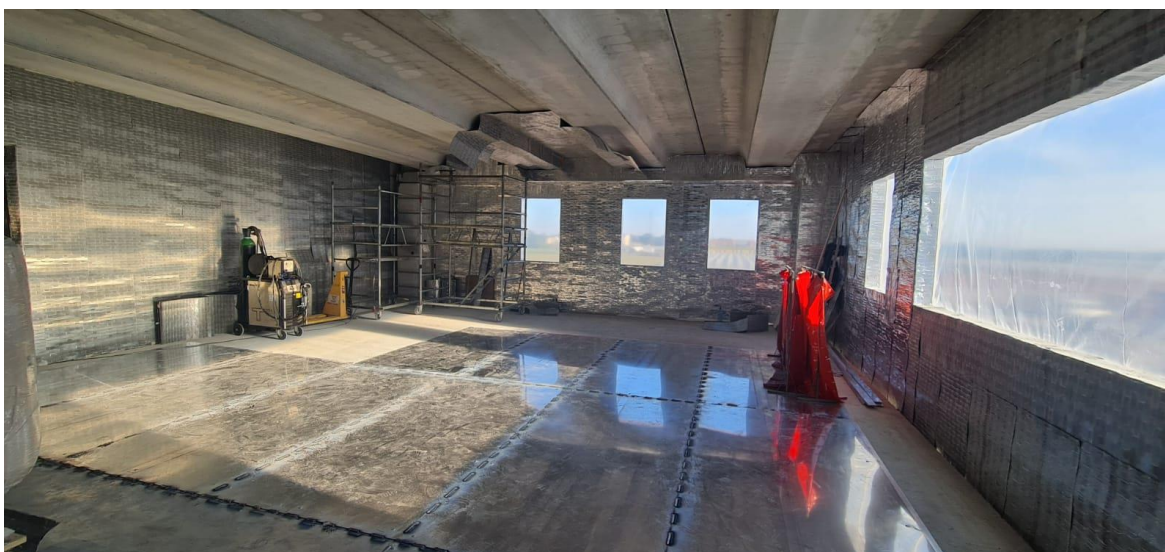

Fig. 4 installation on walls (ArmoFlex) and ceiling (SuperFlex) and floor (ArmoFlex+Aluminum panels)

The information and data embodied in this document and its attachments are strictly confidential and are supplied on the understanding that they will be held confidential and will not be disclosed to other parties.

2) REACTION TO FIRE CLASSIFICATION



EAR N° 0021 I

RAPPORTO DI CLASSIFICAZIONE N. 373480
CLASSIFICATION REPORT No. 373480

Cliente / Customer

G-IRON S.r.l. Unipersonale
Via Giacomo Puccini, 122 - 52100 AREZZO (AR) - Italia

Oggetto / item*

tessuto metallico rivestito da nastro adesivo in alluminio
denominato "G-IRON ARMOFLEX"
metal fabric covered with aluminium adhesive tape named
"G-IRON ARMOFLEX"

Attività / Activity

classificazione al fuoco dei prodotti e degli elementi
di costruzione - parte 1: classificazione in base ai risultati
delle prove di reazione al fuoco
secondo la norma UNI EN 13501-1:2019
fire classification of construction products and building elements -
part 1: classification using data from reaction to fire tests
in accordance with standard UNI EN 13501-1:2019

Risultati / Results

Classificazione
Classification
A1

(*) secondo le dichiarazioni del cliente.
according to that stated by the customer.

Bellaria-Igea Marina - Italia, 27 luglio 2020
Bellaria-Igea Marina - Italy, 27 July 2020

L'Amministratore Delegato
Chief Executive Officer
(Dott. Arch. Sara Lorenza Giordano)

Consente digitalmente da CAIA L'ORBITA GIORDANO

Istituto Giordano S.p.A.
Via Gioacchino Rossini, 2
47814 Bellaria-Igea Marina (RN) - Italia

Tel. +39 0541 343030 - Fax +39 0541 345540
www.giordano.it
info@giordano.it
PEC: ig@giordano.it@pec.it

Codice fiscale/Partenza IVA: 00 549 540 409
Capitale sociale € 1.500,000 i.v.
R.F.A. o.c. C.C.L.A.A. (RN) 156766
Registro Imprese della Romagna - Forlì-Cesena e Rimini n. 00 549 540 409

Commessa:

Order:
84228

Luogo dell'attività:

Activity site:
Istituto Giordano S.p.A. - Strada Erbossa Uno, 80
47043 Gatteo (FC) - Italia

Indice

Pagina

Descrizione dell'oggetto classificato*	2
Riferimenti normativi	2
Rapporti e risultati in supporto a questa	
Classificazione	3
Classificazione e campo di applicazione	4
Contenuto	Page
Description of classified item*	2
Normative references	2
Reports and results in support of this classification	3
Classification and field of application	4

Il presente documento è composto da n. 5 pagine e n. 1 allegato (in formato bilingue (italiano e inglese), in caso di dubbio è valida la versione in lingua italiana) e non può essere riprodotto parzialmente, accontentando parti di interesse a discrezione del cliente, con il rischio di fornire una interpretazione non corretta dei risultati, fatto salvo quanto definito a livello contrattuale.
I risultati si riferiscono solo all'oggetto in esame, così come ricevuto, e sono validi solo nelle condizioni in cui l'attività è stata effettuata.
L'originale del presente documento è costituito da un documento informatico firmato digitalmente ai sensi della Legislazione Italiana applicabile.

This document is made up of 5 pages and 1 annex (in bilingual format (Italian and English), in case of dispute the original version in the Italian only one shall not be reproduced except in full without obtaining prior consent of the client, with the risk of providing an incorrect interpretation of the results, except as defined in contractual level.
The results refer only to the item examined, as received, and are valid only in the conditions in which the activity was carried out.
The original of this document consists of an electronic document digitally signed pursuant to the applicable Italian legislation.

Responsabile Tecnico: /Chief Technician:

Dott. Ing. Giombattista Traina
Responsabile del Laboratorio di Reazione al Fuoco: /
Head of Reaction to Fire Laboratory:
Dott. Ing. Giombattista Traina

Completatore: /Completor: Francesca Manduzi
Revisore: /Reviewer: Per. Ind. Andrea Golinucci

Pagina 3 di 5 /page 3 of 5

The information and data embodied in this document and its attachments are strictly confidential and are supplied on the understanding that they will be held confidential and will not be disclosed to other parties.

3) SHIELDING PERFORMANCE

In conformity with the CEI 211-6 regulation, a distance of 500mm from the screen is chosen for the graph representation of the shielding efficiency.

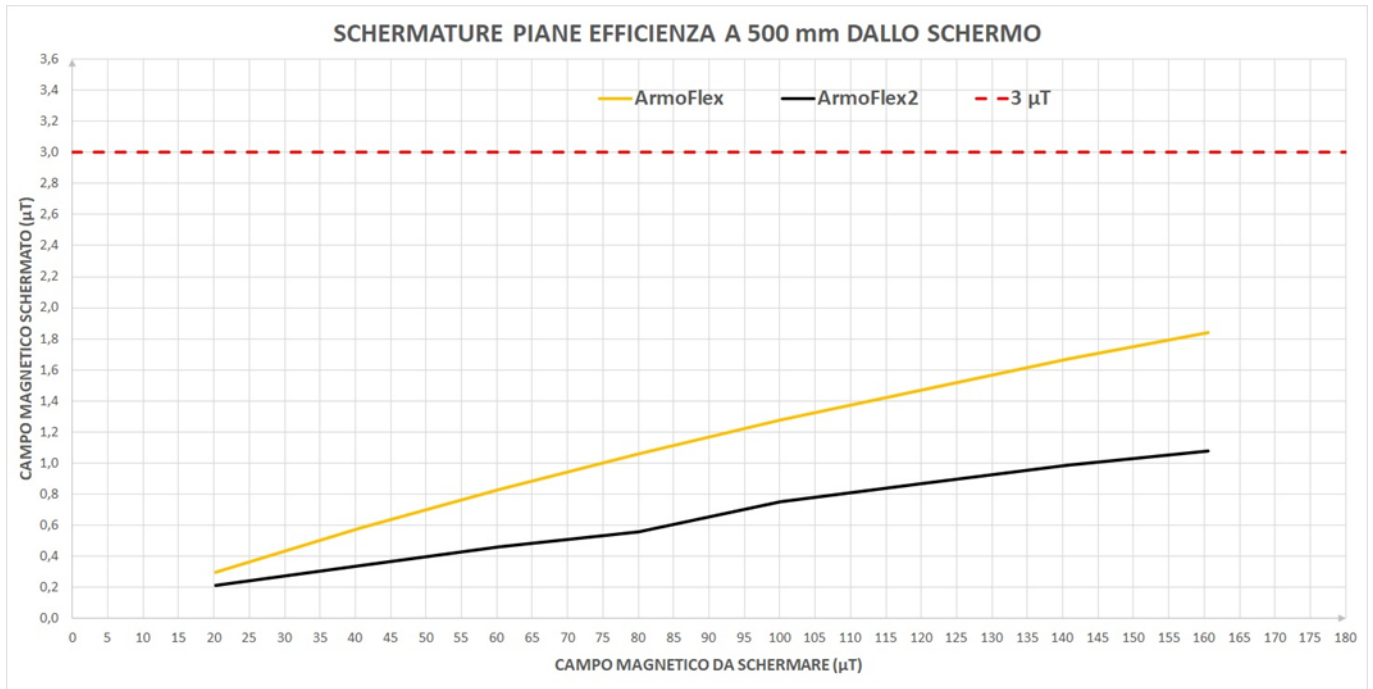

*** average value, G-iron Lab

The information and data embodied in this document and its attachments are strictly confidential and are supplied on the understanding that they will be held confidential and will not be disclosed to other parties.